

ECOPRESS Stationary Compactors

Model COMPACT



ECOPRESS Stationary compactor is designed for pressing cardboard, foil and dry or semi-dry municipal waste, reduces the volume of stored waste and cost of its transportation. The compression ratio is from 1:3 to 1:10 for different types of waste providing the payback of the equipment. Unlike mobile compactor where operation process is suspended for container emptying time, stationary compactor system allows organizing continuous process of waste pressing. Suspension of stationary compactor operation process occurs only during the change of containers. Besides, compared to mobile compactor, larger volume of stationary compactor replaceable containers allows to load and transport larger volume of waste materials.

ESC COMPACT is created to reduce the smaller sized waste and materials. Due to shorter distance of compaction plate movement this machine is highly effective in fast compaction process. Maximum transport capacity of compaction container is 44m³ in relation to a limited length of hook lift collection vehicles. It is suitable for operation in all weather conditions at temperatures from -50°C to +50°C with low noise level. The compaction system is managed by pressure sensors without any mechanical sensors to avoid possible malfunction during operation. Machine is equipped with protective sensors for oil level and overheating. Build in telemetry module supports online connection 24/7 and signals by email and SMS as well as re-program or service requirement notice.

ECOPRESS compactors are available in various different models of loading options, connection to object by stationary hopper, side or front mounted Wheelie Bin Tippers with or without automatic lid opener, front or side hinged backdoor and double end lift up option.

ECOPRESS compactors conform to Health & Safety and CE requirements of EU Directives 2006/42/EC, 89/392EEC, 91/368EEC, 93/44EEC, 93/68EEC on the safety of machinery and equipment and German accident prevention regulations.

Compaction container capacity is from 20 to 44 m³.

TECHNICAL INFORMATION:

Pressing force, tons	28,2 / 39,3
Pressure, bar	210 / 280
Electric motor, kW	5,5 / 7,5
Operating Voltage	230V / 400V / 16-32A
Press plate size, L x W, mm	1850 x 500
Loading chamber volume, m ³	2,77
Loading chamber size - top, L x W, mm	1850x1120
Loading chamber size - bottom, L x W, mm	1850x1020
Loading height, mm	1510
Output capacity per cycle, m ³	0,94
Output capacity per hour, m ³ /h	77 / 82
Compacting cycle, sec	43 / 40
Container volume, m ³	20 - 44
Cardboard payload in 30m ³ , tons	up to 5 / 7,5
Incineration waste payload in 30m ³ , tons	up to 8 / 15

ESC COMPACT OVERALL DIMENSIONS:

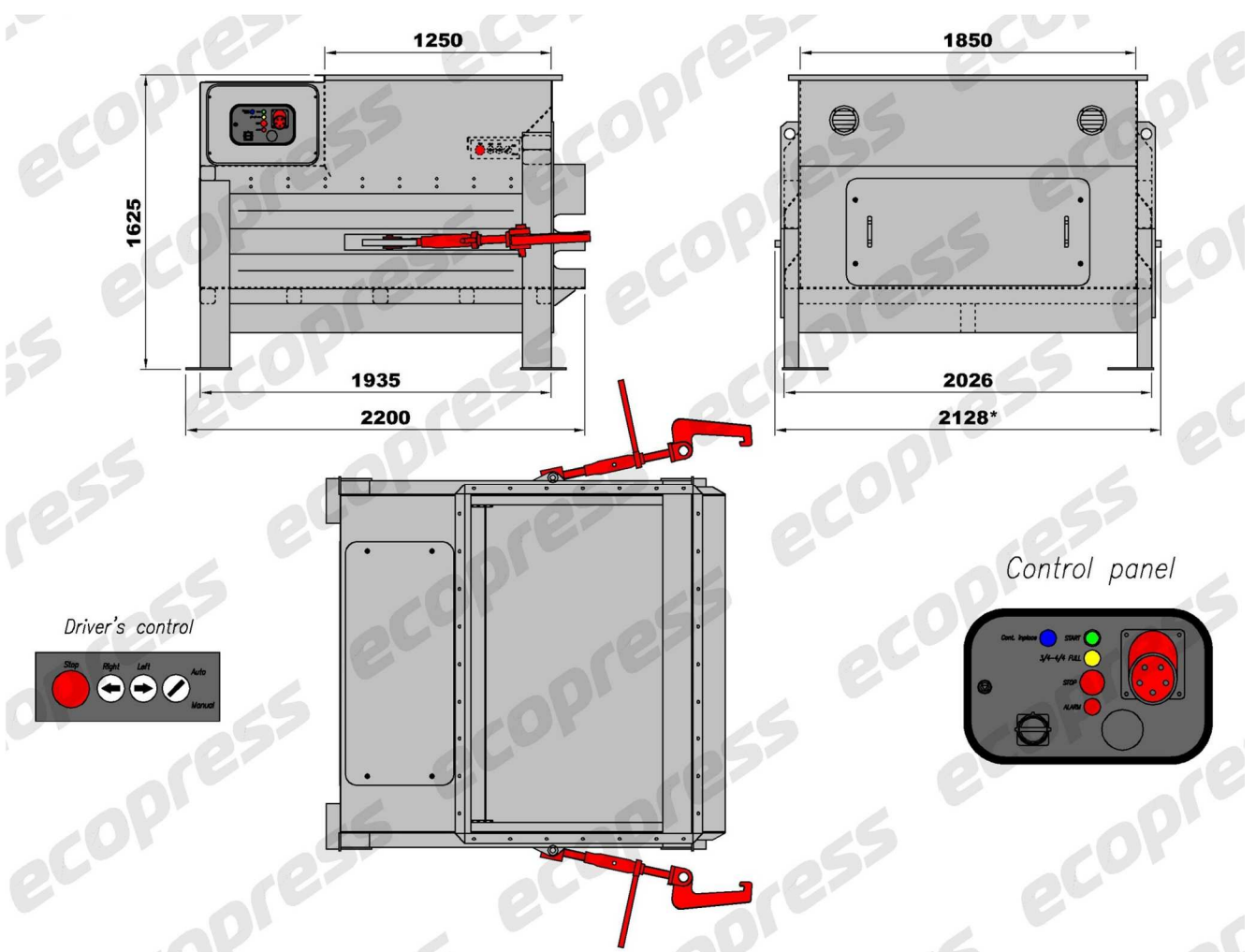

Features:

For hooklift/roll-off tippers
Container 80 and 100% full light
Ram with plastic fine scraper at the bottom (ideal for scraps of paper)
Rubber seal on cylinder chamber
Pendulous retaining claws prevent the waste from springing back
Problem-free emptying supported by three-sided conical container body or floating roof
Discharge door with ratchet closure, hinges on the side
Cylinder mounted in rotatable eyelets
Maintenance friendly electrical switch cabinet and hydraulic unit are easily accessible from the side and from above.
Electronic safety controller is easily expandable for many additional functions
Container sandblasted and painted as per EN ISO 12944 C3M

Options:

End position of the ram "open" or "closed"
Cable remote control
Pendulous steel scraper in front of the ram
Low feed opening 1320mm for comfortable loading
Cover over filling opening optionally
Discharge door with seal
Maintenance hatch with safety limit switch
Additional integrated or portable container tipping mechanisms
Fill level, error or service requirement notification via GSM
Bin Lifting device integrated or stationary with own power pack
230/380V switch box panel
Timer to start / stop compaction
Automatic start with photo sensor
Oil heating system
Oil cooling system
Steel lid with 2 gas cylinders
Aluminum lid with 2 gas cylinders
High sides of loading chamber
High sides of loading chamber with side loading hatches
Waste feeding channel
Guiding rails, 3m or 6m

